

SIP Industrial Products Limited
Gelders Hall Road
Shepshed
Loughborough
Leicestershire
LE12 9NH
United Kingdom

SIP Fireball Diesel Heaters

Air & Gear Pump Models



SIP Codes 09590 09591 09592 09593 09594 09595 09586 09597 09598

For help or advice please
contact your distributor, or sip
directly on: Tel.: 01509 500400
Email:sales@sip-group.com or
technical@sip-group.com www.sip-
group.com

Sip
SIP INDUSTRIAL

<i>Page</i>	<i>Contents</i>
3	Safety Symbols
4 - 6	Safety Instructions
6 - 7	Electrical Connection
8	Guarantee
9	Technical Specification
10 - 11	Assembly
11 - 12	Getting To Know Your Heater
13 - 15	Operation
15 - 16	Maintenance
17	Troubleshooting
18	Wiring Diagram
19	Exploded Drawings & Parts Lists
22	UK Declaration of Conformity
23	EU Declaration of Conformity

SAFETY SYMBOLS



Danger / Caution: This image indicates risk of personal injury and/or the possibility of damage.



Warning: This image indicates risk of electrical injury or damage!



Note: This image indicates supplementary information.



Important: Please read the following instructions carefully, failure to do so could lead to serious personal injury and / or damage to the item.

SAFETY INSTRUCTIONS

IMPORTANT: Please read the following instructions carefully, failure to do so could lead to serious personal injury and / or damage to the heater.

When using your heater, basic safety precautions should always be followed to reduce the risk of fire, electric shock, personal injury and / or damage to the heater. Read all these instructions before operating the heater and save this user manual for future reference. SIP recommends that this heater should not be modified or used for any application other than that for which it was designed. If you are unsure of its relative applications do not hesitate to contact us and we will be more than happy to advise you.

KNOW YOUR HEATER: Read and understand the owner's manual and labels affixed to the heater. Learn its applications and limitations, as well as the potential hazards specific to it. **DO NOT USE THE HEATER IN DANGEROUS ENVIRONMENTS:** Do not use your heater in damp or wet locations, or expose it to rain. Always provide adequate space around the heater.

DO NOT OPERATE THE HEATER IN EXPLOSIVE ATMOSPHERES: Do not use the heater in the presence of flammable liquids, gases, dust or other combustible sources.

KEEP CHILDREN AND UNTRAINED PERSONNEL AWAY FROM THE WORK AREA: All visitors should be kept at a safe distance from the work area.

STORE THE HEATER SAFELY WHEN IT IS NOT IN USE: The heater should be stored in a dry, locked cupboard, or similar when not in use wherever possible and out of the reach of children.

STAY ALERT: Always watch what you are doing and use common sense. Do not operate the heater when you are tired or under the influence of alcohol or drugs.

DISCONNECT THE HEATER FROM THE MAINS SUPPLY: When not in use, before servicing and when refuelling etc.

AVOID UNINTENTIONAL STARTING: Make sure the switch is in the OFF position before connecting the heater to the mains supply.

DO NOT ABUSE THE MAINS LEAD: Never carry the heater by the mains lead or pull it to remove the plug from the mains socket. Keep the mains lead away from heat, oil and sharp edges. If the mains lead is damaged, it must be replaced by the manufacturer or its service agent or a similarly qualified person in order to avoid unwanted hazards. **HAVE YOUR HEATER REPAIRED BY A QUALIFIED PERSON:** The heater is in accordance with the relevant safety requirements. Repairs should only be carried out by qualified persons using original spare parts, otherwise this may result in considerable danger to the user.

- **DANGER!** Risk of carbon monoxide poisoning; failure to provide proper ventilation could result in serious illness or death.
- Check that the heater is in sound condition and good working order. Take immediate action to repair or replace damaged parts.
- Use recommended parts only - Unapproved parts may be dangerous and will invalidate the warranty.
- Only use kerosene or diesel to fuel your heater, in accordance with instructions contained in this manual.
- **WARNING!** only use the heater in well ventilated areas. Ensure continuous ventilation from outside of the building is provided to the heater and the operating area.
- Keep the front of the heater a minimum of 2.4 metres (8ft) from any combustible materials (i.e. wooden items, cloth, plastics, paper, etc).
- Only operate on a level and stable surface.
- **WARNING!** Do not use the heater near flammable material, liquids, solids, gases or compressed gas cylinders.
- Do not use the heater in closed rooms, living areas, basements or below ground level.
- Do not allow untrained persons to operate the heater and do not operate the heater without all covers etc. correctly fitted.

- Do not move or handle the heater when it is running or still hot - always turn it off and allow it to cool.
- Do not leave the heater unattended when in use. Switch the heater off and unplug from the mains supply before leaving the work area.
- Do not fill the fuel tank whilst the heater is running or still hot - always turn it off and allow it to cool.
- Do not over-fill the fuel tank and always wipe up any spilt fuel immediately.
- Do not obstruct the air inlet (rear) and air outlet (front) of the heater.
- Do not use any form of ducting in front or at the rear of the heater.
- Do not allow children or animals near the heater, particularly when in use, or while still hot.
- **WARNING! RISK OF ELECTRIC SHOCK.** Do not expose the heater to water spray, rain, dripping water or moisture of any kind.
- Do not operate the heater when you are tired or under the influence of alcohol, drugs or intoxicating medication.
- Do not touch the heater outlet or dome when first switched off as these are very hot and will take time to cool.
- Ensure that the heater is correctly turned off when not in use and store in a safe, dry area, out of reach of children.
- Do not unplug the heater to switch it off - always use the on/off switch.
- Use this heater only in well ventilated areas! Provide at least a three square foot (2,800 sq cm) opening of outside air for every 100,000 Btu/hr of heat rating.
- People with breathing problems should consult a physician before using the heater.
- Carbon Monoxide Poisoning: Early signs of carbon monoxide poisoning resemble flu-like symptoms such as headaches, dizziness, and / or nausea. If you have these symptoms, your heater may not be working properly, or there is not enough ventilation.
- Get fresh air at once! Have the heater checked and / or ensure there is enough ventilation. Some people are more affected by carbon monoxide than others. These include pregnant women, those with heart or lung problems, anemia, or those under the influence of alcohol, or at high altitudes. - Never use this heater in living or sleeping areas.
- **NEVER** use fuels such as gasoline, benzene, paint thinners, or other oil compounds in this heater - **RISK OF FIRE OR EXPLOSION.**
- **NEVER** use this heater where flammable vapours may be present.
- **NEVER** refill the heater's fuel tank while the heater is operating or still hot. This heater is **EXTREMELY HOT** while in operation.
- Keep all combustible materials away from this heater.

MINIMUM CLEARANCE:

Outlet (front): 8 feet (250 cm)

Sides, Top and Rear: 4 feet (125 cm)

- **NEVER** block air inlet (rear) or air outlet (front) of heater.
- **NEVER** move or handle heater while still hot.
- **NEVER** transport heater with fuel in its tank.
- Beware that as the heater is fitted with a thermostat, the heater may start at any time.
- **ALWAYS** locate heater on a stable and level surface.
- **ALWAYS** keep children and animals away from heater.
- Use only diesel or kerosene to fuel the heater.



WARNING: Risk of Electric Shock!

- Use only the electrical power (voltage and frequency) specified on the model plate of the heater.
- Use only a UK three-prong, grounded outlet and where required, extension lead.
- ALWAYS unplug the heater when not in use.



CAUTION: The warnings and cautions mentioned in this user manual can not cover all possible conditions and situations that may occur. It must be understood by the operator that common sense and caution are factors which cannot be built into this product, but must be applied.

ELECTRICAL CONNECTION

WARNING! It is the responsibility of the owner and the operator to read, understand and comply with the following:

You must check all electrical products, before use, to ensure that they are safe. You must inspect power cables, plugs, sockets and any other connectors for wear or damage.

You must ensure that the risk of electric shock is minimised by the installation of appropriate safety devices; A residual current circuit Breaker (RCCB) should be incorporated in the main distribution board. We also recommend that a residual current Device (RCD) is used. It is particularly important to use an RCD with portable products that are plugged into a supply which is not protected by an RCCB. If in any doubt consult a qualified electrician.

CONNECTING THE POWER SUPPLY:

This SIP heater is fitted with a standard 230v ~ 13 amp type plug. Before using the heater, inspect the mains lead and plug to ensure that neither are damaged. If any damage is visible have the heater inspected / repaired by a suitably qualified person. If it is necessary to replace the plug a heavy duty impact resistant plug would be preferable. The wires for the plug are coloured in the following way:

Blue		Neutral
Brown		Live
Yellow & Green		Earth
<i>Earth Terminal Symbol</i>		

As the colours of the wires may not correspond with the markings in your plug, proceed as follows: The wire which is coloured blue, must be connected to the terminal marked with N or coloured black. The wire which is coloured brown, must be connected to the terminal, which is marked L or coloured red. The wire which is coloured yellow / green should be connected to the terminal which is coloured the same or marked as in the table above.

Always secure the wires in the plug terminal carefully and tightly. Secure the cable in the cord grip carefully.

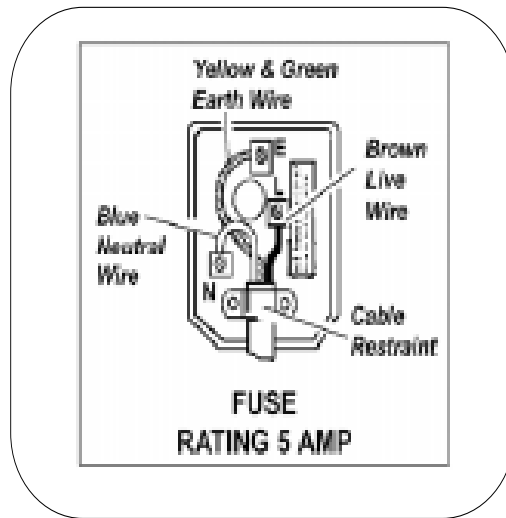

Warning: Never connect live or neutral wires to the earth terminal of the plug. Only fit an approved plug with the correct rated fuse. If in doubt consult a qualified electrician.



Note: Always make sure the mains supply is of the correct voltage and the correct fuse protection is used.



Note: If an extension lead is required in order to reach the mains supply; ensure that this too is rated for the correct voltage and fuse rating.



Note: The cross section of the extension lead should be checked so that it is of sufficient size so as to reduce the chances of voltage drops.

GUARANTEE

This SIP heater is covered by a 24 month parts and labour warranty covering failure due to manufacturers defects. This does not cover failure due to misuse or operating the machine outside the scope of this manual.

Consumable items such as air filter, pump filter, fuel filter etc are not covered under warranty.

In the unlikely event of warranty claims, contact your distributor as soon as possible.



Note: Proof of purchase will be required before any warranty can be honoured.

TECHNICAL SPECIFICATION

<i>Model</i>	<i>09590</i>	<i>09591</i>	<i>09592</i>	<i>09593</i>
Input Voltage	230v ~ 50Hz	230v ~ 50Hz	230v ~ 50Hz	230v ~ 50Hz
Motor	230w	230w	230w	240w
Fuel	Diesel / Paraffin	Diesel / Paraffin	Diesel / Paraffin	Diesel / Paraffin
Pump Type	Air Pump	Air Pump	Air Pump	Air Pump
Heat Output	50,000BTU / 15kW	75,000BTU / 22kW	75,000BTU / 22kW	100,000BTU / 30kW
Approx. Heating Area	350m ³	530m ³	530m ³	700m ³
Fuel Tank	18L	18L	26L	26L
Approx. Fuel Consumption	1.4L/Hr	1.9L/Hr	1.9L/Hr	2.8L/Hr
Heater Dimensions	800 x 320 x 430mm	800 x 320 x 430mm	805 x 460 x 590mm	805 x 460 x 590mm
Packaged Dimensions	820 x 350 x 435mm	820 x 350 x 435mm	870 x 335 x 505mm	870 x 335 x 505mm
Net Weight	17.1kg GW / 14.6 kg NW	17.1kg GW / 14.6 kg NW	22.8kg GW / 19.7kg NW	22.8kg GW / 19.7kg NW

<i>Model</i>	<i>09594</i>	<i>09595</i>	<i>09596</i>
Input Voltage	230v ~ 50Hz	230v ~ 50Hz	230v ~ 50Hz
Motor Power	340w	340w	340w
Fuel	Diesel / Paraffin	Diesel / Paraffin	Diesel / Paraffin
Pump Type	Air Pump	Air Pump	Air Pump
Heat Output	140,000BTU / 41kW	175,000BTU / 51kW	215,000BTU / 63kW
Approx. Heating Area	1060m ³	1230m ³	1500m ³
Fuel Tank	65L	65L	65L
Approx. Fuel Consumption	3.8L/Hr	4.8L/Hr	5.7L/Hr
Heater Dimensions	1150 x 530 x 660mm	1150 x 530 x 660mm	1150 x 530 x 660mm
Packaged Dimensions	1220 x 415 x 560mm	1220 x 415 x 560mm	1220 x 415 x 560mm
Net Weight	32.8kg GW / 28.7kg NW	32.8kg GW / 28.7kg NW	32.8kg GW / 28.7kg NW

<i>Model</i>	<i>09597</i>	<i>09598</i>
Input Voltage	230v ~ 50Hz	230v ~ 50Hz
Motor Power	550w	550w
Fuel	Diesel / Paraffin	Diesel / Paraffin
Pump Type	Gear Pump	Gear Pump
Heat Output	275,000BTU / 80kW	350,000BTU / 105kW
Approx. Heating Area	1930m ³	2460m ³
Fuel Tank	80L	80L
Approx. Fuel Consumption	7.5L/Hr	9.5L/Hr
Heater Dimensions	1155 x 590 x 750mm	1155 x 590 x 750mm
Packaged Dimensions	1220 x 465 x 660mm	1220 x 465 x 660mm
Net Weight	41.6kg GW / 38.8kg NW	41.6kg GW / 38.8kg NW

1. Insert the **wheel axle (1)** through the holes in the **wheel frame (6)**.
2. Secure the axle in position using the **split pins** as in **Figures A & B**.
3. Fit the wheels onto the **axle (1)** and secure with **washers (3) & nuts (4)** provided.
4. Place the **main heater & chassis frame (10)** on to the **wheel frame (6)**.
5. Use the **short screws (7)** to secure the **top body frame (10)** onto the **fuel tank (8)**.
6. Use the **long screws (9)** to secure the **top frame and wheel frame (10)** together.
7. Tighten all screw assemblies.

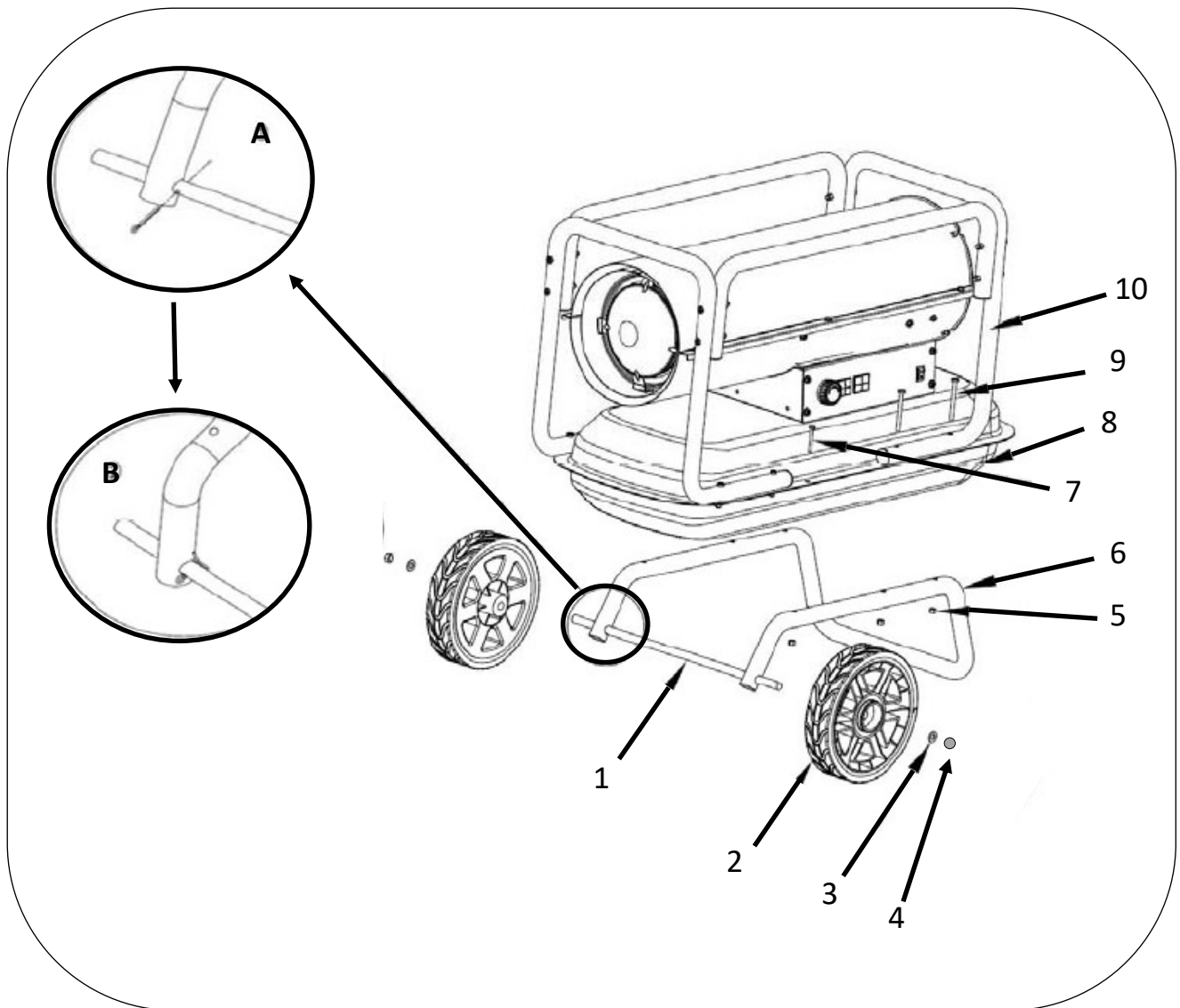

Item	Description	Item	Description
1	Wheel Axle	6	Wheel Frame
2	Wheel	7	M5 x 35mm Screw
3	Washer	8	Fuel Tank
4	M8 Nut	9	M5 x 60mm Screw
5	M5 Nut	10	Heater & Body Assembly

Minimum assembly is required for the models **09590 Fireball 50-15XD** & **09591 Fireball 75-22XD**. All that is required is to fasten the "D" shaped handle to the top of the heater with the screws provided.

GETTING TO KNOW YOUR HEATERS

AIR PUMP STYLE:

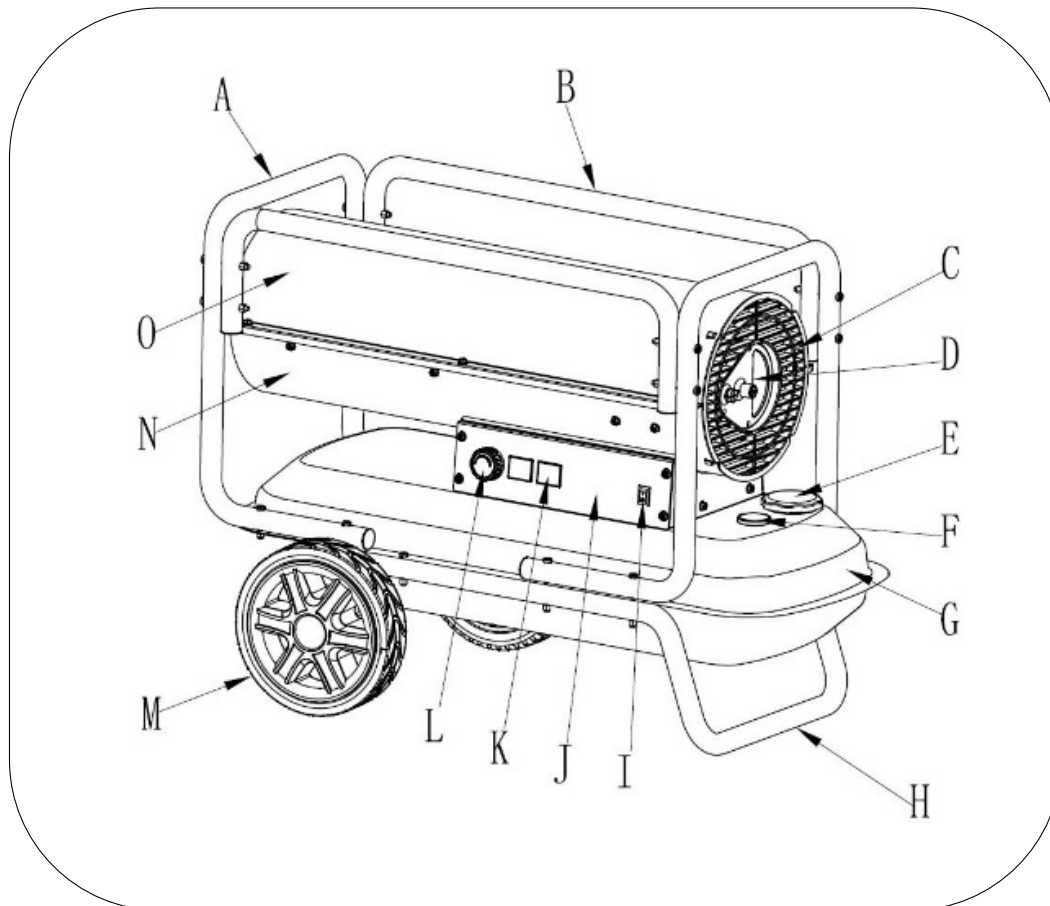

<i>Item</i>	<i>Description</i>	<i>Item</i>	<i>Description</i>
A	Rear Tubular Frame	I	On / Off Switch
B	Side Tubular Frame	J	Control Panel
C	Rear Grille - Air Inlet	K	Twin Digital Displays
D	Motor / Air Pump	L	Thermostat Control Knob
E	Fuel Tank Cap	M	Wheel
F	Fuel Gauge	N	Lower Outer Cover
G	Fuel Tank	O	Upper Outer Cover
H	Wheel Tubular Frame		

GEAR PUMP STYLE:

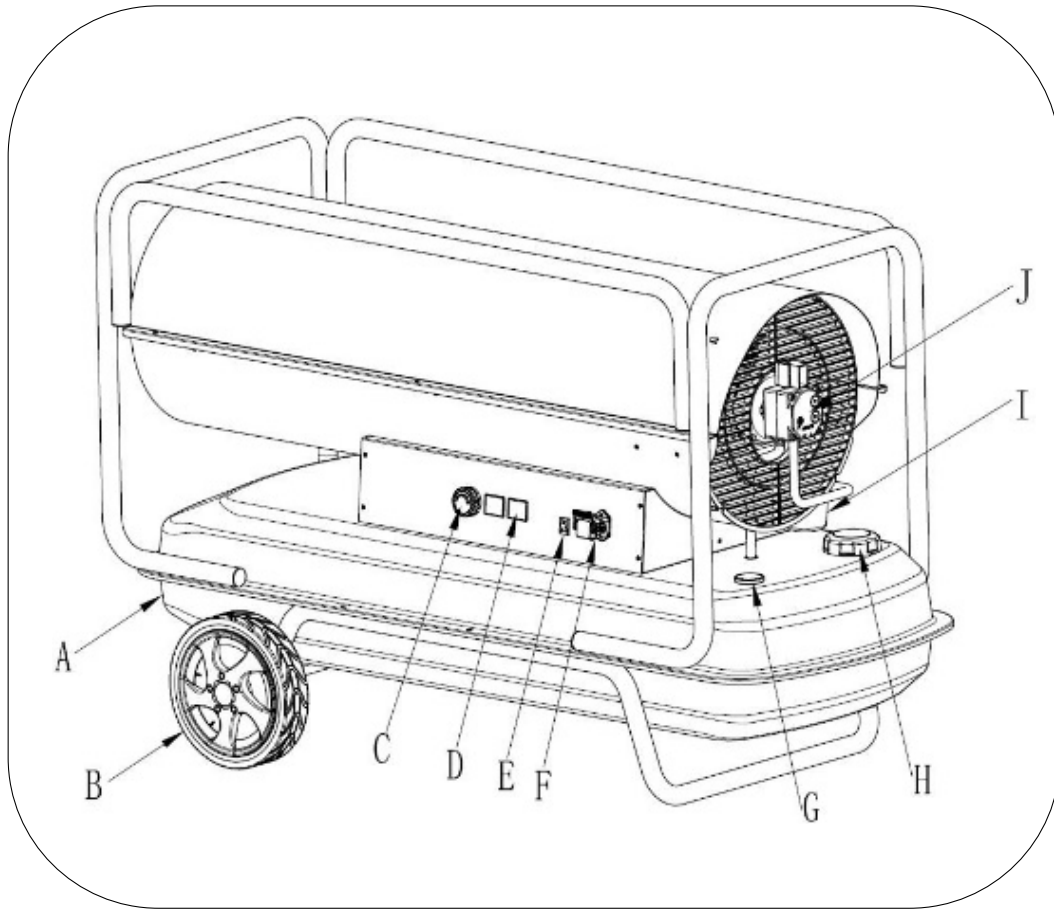

<i>Item</i>	<i>Description</i>	<i>Item</i>	<i>Description</i>
A	Fuel Tank	F	External Temperature Sensor Socket
B	Wheel	G	Fuel Gauge
C	Thermostat Control Knob	H	Fuel Tank Cap
D	Twin Digital Display	I	External Fuel Filter
E	On / Off Switch	J	Gear Fuel Pump

PREPARATION:

1. Never use highly volatile fuels such as petrol / gasoline.
2. Only refuel when the heater is OFF and the chamber has cooled.
3. Please use clean / new Diesel, Paraffin or Kerosene fuel.
4. Wash off immediately any Diesel that comes into contact with your skin or any body parts.
5. After use the outer casing will remain hot -Do Not Touch!
6. Ensure the fuel filter is clean and unblocked prior to use.

FUELING:

1. Make sure heater is disconnected from the power supply, and the power switch is in the "O" position.
2. Put the machine in a stable place, unscrew the fuel tank cap, and add fuel; do not overfill!
3. Make sure the tank is free of contaminants including water prior to filling.
4. Add diesel fuel into the fuel tank, and tighten the fuel tank cap clockwise after refueling.

IGNITION:

1. Check the fuel tank to confirm whether there is enough Diesel, Paraffin or Kerosene.
2. After the ignition operation, please do not approach the flame side of the heater; maintain a distance of 3.5 metres in front, 2 metres above, and 2 metres on both sides;(as shown below)
3. Please stop using it if there is a smell of burning or signs of burning.

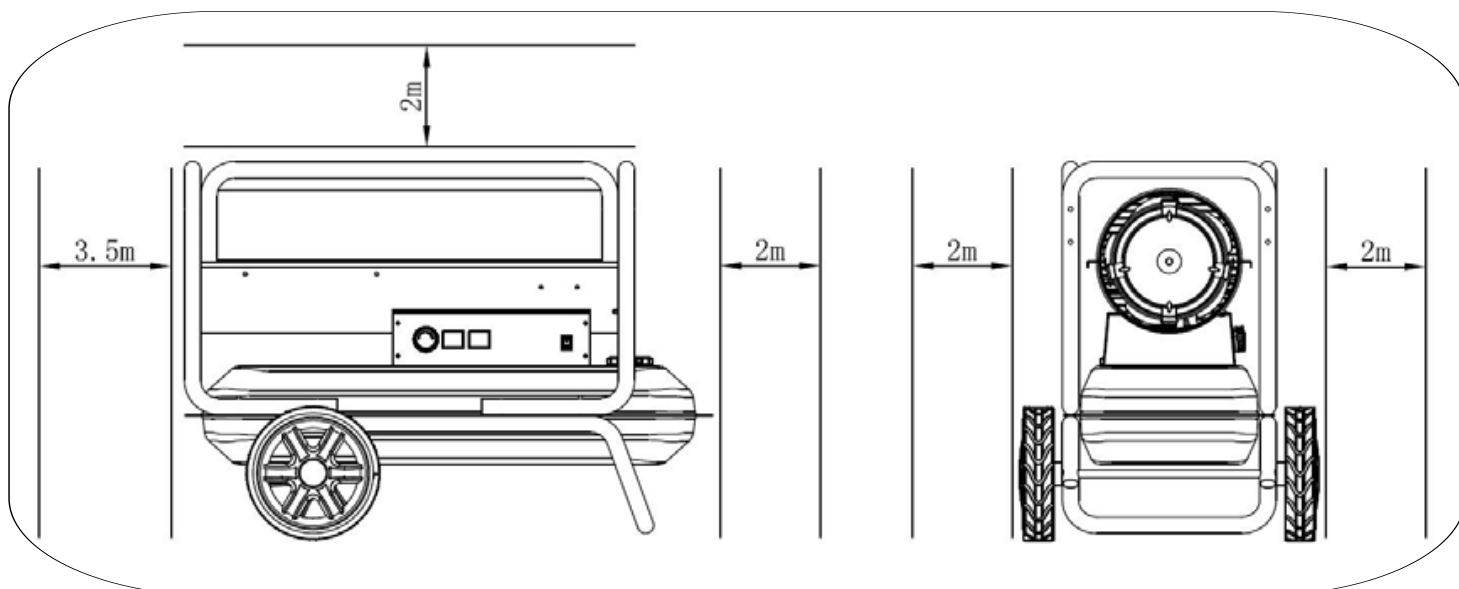

TO START THE HEATER:

- A. Place the heater on a level stable surface.
- B. Plug the mains plug in the power socket. Switch on the socket and also the ON/OFF switch on the side of the heater.
- C. Adjust the Thermostat Control Knob to the desired temperature.
- D. The target temperature can be set on the Digital Display Models. Note: Heater will only start if the Thermostat is set above ambient temperature.
- E. At this point the motor / pump will start up, the ignition will ignite the fuel and the heater will start automatically.



Important: The first ignition of the heater should be carried out outdoors - This will allow any oils etc. used during the manufacturing process to be burnt off.



NOTE: If there is no combustion after starting, please press the power switch to the Off position to reset. Press the ON/OFF switch to On again and set the thermostat knob above the ambient temperature. If the heater fails to start contact SIP Customer Services.

TO STOP THE HEATER:

- A. Turn the ON/OFF switch to the OFF position.
- B. The flame will distinguish but the motor will continue to run for approx. 2 minutes and then stop. (this function is not on models 09590 & 09591).
- C. Unplug the heater from the mains socket.

TO RESTART THE HEATER:

Wait at least 10 seconds and then repeat the steps under, "To Start the Heater".

SAFETY DEVICES:

Flame-Out Sensor: The heater utilizes a photocell to monitor the flame in the combustion chamber during normal operation. It will cause the heater to shut off should the burner flame extinguish.

Delay Protection: When the heater is switched to the OFF position after use the flame will distinguish but the motor fan will continue to run for approx. 2 minutes to cool the heater. (not available 09590 09591)

Power Failure Protection: After power failure the heater will stop. Should the power be restored when the heater is still switched ON, the heater **will not** automatically start-up. To restart turn the heater ON/OFF switch to OFF. Wait for 10 seconds and switch back to the ON position.

Overheat Protection: This heater is equipped with a Temperature Limit Control designed to turn the heater off should the internal temperature rise to an unsafe level. If this device activates and turns your heater off, it may suggest that the heater requires a service.

OPERATING AMBIENT TEMPERATURE:

The permissible ambient temperature range of this product is -25°C to 65°C.

MAINTENANCE



WARNING! Air contaminants taken into the heater may affect the heat output, damage the unit and may cause health problems.

Example: Body-shop filler dust/paint overspray will damage the motor bearing, clog the filters and contaminate the combustion chamber causing flame flutter and health hazards. Please note that any parts damaged by filler dust/paint overspray or similar will not be covered by warranty. Additionally, a cleaning charge will be made for any heaters damaged by filler dust/paint overspray or similar. The following is only a guide; if the heater is used in heavy dust environments the servicing frequency should be adjusted accordingly to prolong the life of the heater.



WARNING! Never service the heater while it is plugged in or while still hot!



USE ONLY ORIGINAL REPLACEMENT PARTS - Use of third-party or other alternate components may void your warranty and cause unsafe operating conditions. .

CHECKING / CLEANING THE FUEL TANK:

1. Elevate the rear of the heater and place a collection container underneath the drain plus. If there is any foreign matter / contamination or water in the tank, clean or remove. (see below).
2. Loosen the drain bolt with a wrench to drain the contents of the tank.
3. Once empty, tighten the drain bolt and wipe the oil and water off the fuselage.

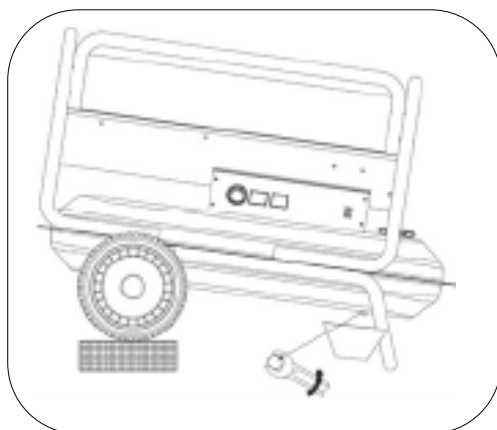

AIR INTAKE FILTER:

Replace or wash and dry with mild soap and water every 360 hours of operation, or sooner in very dusty environments.

AIR OUTPUT FILTER:

Replace every 360 hours of operation, once a year or sooner if operated in dusty environments.

PHOTOCELL:

Remove the upper casing.

Remove the photocell from its mounting.

Clean the photocell with a cotton swab.

Re-install the photocell.

Re-fit the upper casing.

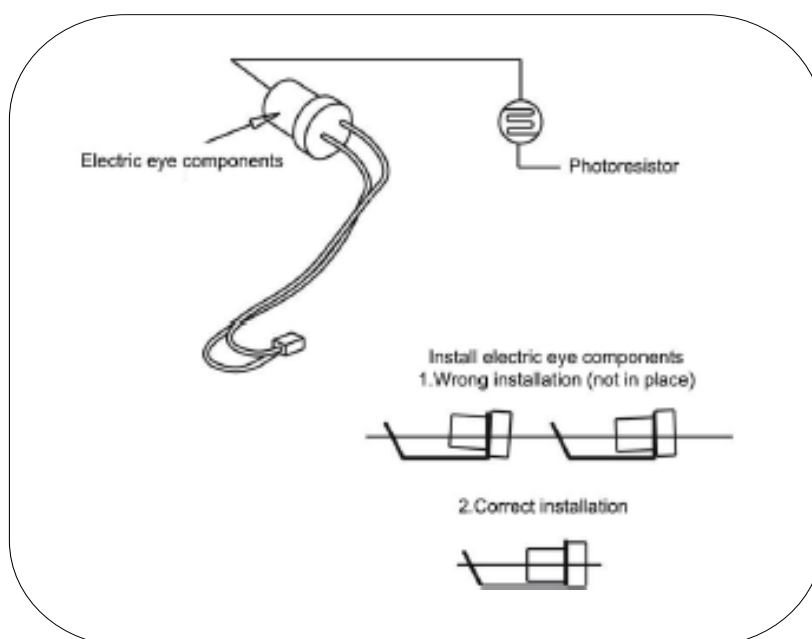

STORAGE:

- Unscrew the fuel cap.
- Use a siphon, or similar suitable for diesel to remove the contents of the fuel tank.
- Using a small amount of clean diesel, rinse and swirl the paraffin inside the fuel tank.
- Empty tank fully.
- Never mix water with the paraffin as it will cause the tank to rust.
- Never store old fuel in the tank over long periods when the heater is not in use.
- Store heater in a safe, dry well ventilated area away from children.
- Be sure that the storage area is free of dust and corrosive vapours.
- Re-pack the heater in the original shipping material.
- Keep the manual in an easily accessible place.

TROUBLESHOOTING



Important: The first ignition of the heater should be carried out outdoors - This will allow any oils etc. used during the manufacturing process to be burnt off.

<i>Error Code</i>	<i>Cause</i>	<i>Solution</i>
E1	No Fuel In The Tank	Fill Tank With Fuel
	Dirty Photocell	Clean Photocell Lens
	Burner Issue	Replace Fuel / Clean Fuel Filter
	Defective Ignitor	Check Ignitor Connection / Clean Ignitor Electrode
E2	Temperature Sensor Fault	Defective Temperature Sensor / Sensor Connection

<i>Symptom</i>	<i>Not Working</i>	<i>No Flame</i>	<i>Cutting Out</i>	<i>Fuel Leak</i>	<i>Smoking / Fumes</i>	<i>Excessive Flame</i>	<i>Solution</i>
No Power	✓						Check mains supply / On-Off Switch / Blown Fuse
Power Cut	✓						Turn heater Off - Wait 10 seconds and switch back On
Low Voltage					✓	✓	Find cause of volt drop i.e extension lead
Fuel Cap Breather Blocked			✓				Clean breather hole
Filter Blocked			✓				Clean the filter
Nozzle Blocked			✓				Clean fuel nozzle
Lack of fuel			✓				Re-fuel the tank
Water / Moisture in fuel tank		✓	✓				Clean the fuel tank
Contaminated Fuel		✓	✓		✓	✓	Clean the fuel tank & fill with new clean fuel
Fuel discharge screw is loose				✓			Tighten discharge screw

WIRING DIAGRAM

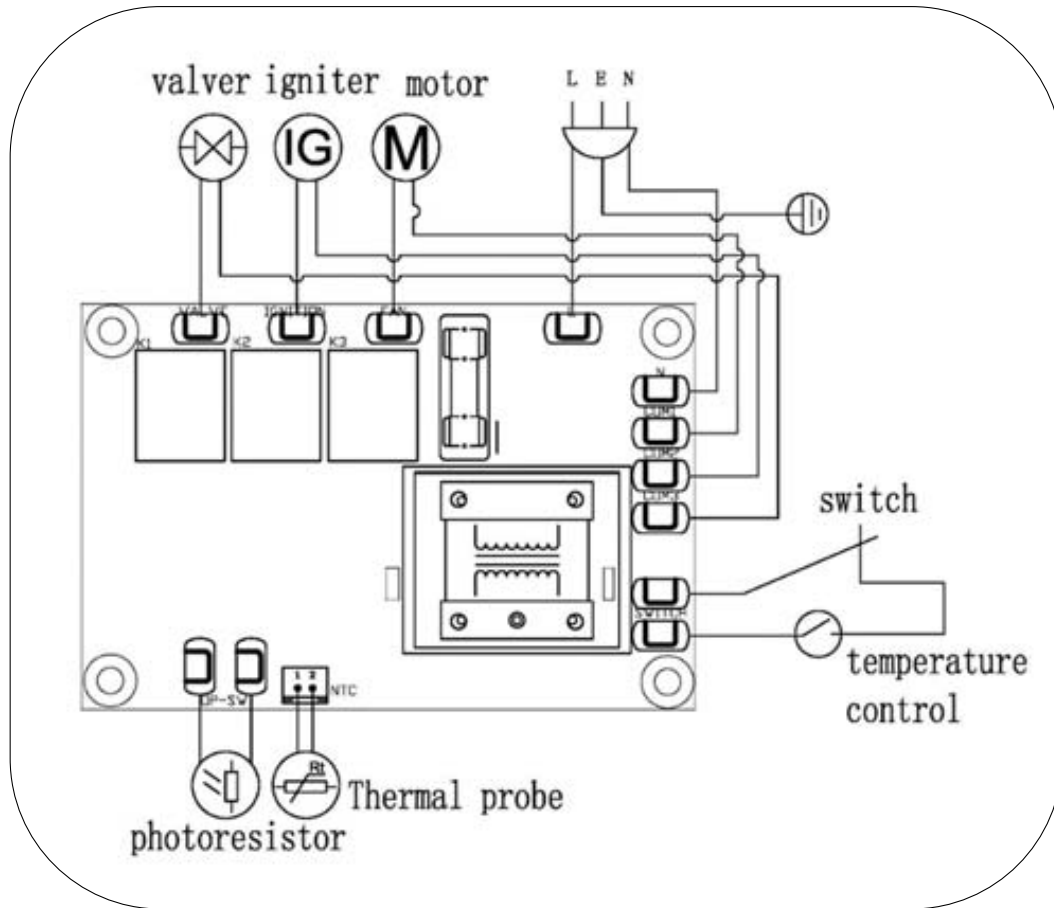

For Exploded Drawings & Parts List visit: www.sip-group.com

Declaration of Conformity

We

SIP (Industrial Products) Ltd Gelders
Hall Road
Shepshed
Loughborough
Leicestershire
LE12 9NH
England

As the manufacturer within the UK, England, Scotland & Wales, declare that the

- SIP Fireball XD50 Diesel Heater: SIP Code 09590
- SIP Fireball XD75 Diesel Heater: SIP Code 09591
- SIP Fireball XD75 Wheel Mounted Diesel Heater: SIP Code 09592
- SIP Fireball XD100 Diesel Heater: SIP Code 09593
- SIP Fireball XD140 Diesel Heater: SIP Code 09594
- SIP Fireball XD175 Diesel Heater: SIP Code 09595
- SIP Fireball XD215 Diesel Heater: SIP Code 09596
- SIP Fireball XD275 Diesel Heater: SIP Code 09597
- SIP Fireball XD350 Diesel Heater: SIP Code 09598

- Supply of Machinery (Safety) Regulations 2008
- The Restriction of the Use of Certain Hazardous Substances in Electrical and Electronic Equipment Regulations 2012
- Electromagnetic Compatibility Regulations 2016

Conforms to the requirements of the following directive(s), as indicated.

And the relevant harmonised standard(s), including:

- BS EN60335-1:2012+A11:2014+A13:2017+A1:2019+A14:2019+A2:2019+A15:2015
- BS EN60335-2-102:2016
- BS EN62233:2008
- BS EN 13842:2004
- BS EN IEC 55014-1:2021
- BS EN IEC55014-2:2021
- BS EN IEC 61000-3-2:2019+A1:2021
- BS EN61000-3-3:2013+A2:2021

Signed: 

Mr P. Ippaso - Director - SIP (Industrial Products) Ltd
Date: 29/04/2023



Declaration of Conformity

We

SIP (Machinery Europe) Ltd
ASM Chartered Accountants
First Floor Block One
Quayside Business Park
Dundalk
County Louth
Republic of Ireland

- SIP Fireball XD50 Diesel Heater: SIP Code 09590
SIP Fireball XD75 Diesel Heater: SIP Code 09591
SIP Fireball XD75 Wheel Mounted Diesel Heater: SIP Code 09592
SIP Fireball XD100 Diesel Heater: SIP Code 09593
SIP Fireball XD140 Diesel Heater: SIP Code 09594
SIP Fireball XD175 Diesel Heater: SIP Code 09595
SIP Fireball XD215 Diesel Heater: SIP Code 09596
SIP Fireball XD275 Diesel Heater: SIP Code 09597
SIP Fireball XD350 Diesel Heater: SIP Code 09598

As the manufacturer's authorised representative within the EC

- o Machinery Directive 2006/42/EC
o Restriction of the Use of certain Hazardous Substances in Electrical and Electronic Equipment (RoHS) - Directive 2011/65/EU & (EU)2015/863
o Electromagnetic Compatibility - Directive 2014/30/EU

Conforms to the requirements of the following directive(s), as indicated.

And the relevant harmonised standard(s), including:

- EN60335-1:2012+A11:2014+A13:2017+A1:2019+A14:2019+A2:2019+A15:2015
EN60335-2-102:2016
EN62233:2008
EN 13842:2004
EN IEC 55014-1:2021
EN IEC55014-2:2021
EN IEC 61000-3-2:2019+A1:2021
EN61000-3-3:2013+A2:2021

Handwritten signature of Paul Ippaso

Signed:

Mr P. Ippaso - Director - SIP (Machinery Europe) Ltd
Date: 29/04/23.





Please dispose of packaging for the product in a responsible manner. It is suitable for recycling. Help to protect the environment, take the packaging to the local amenity tip and place into the appropriate recycling bin.

Never dispose of electrical equipment or batteries in with your domestic waste. If your supplier offers a disposal facility please use it or alternatively use a recognised recycling agent. This will allow the recycling of raw materials and help protect the environment.

**FOR HELP OR ADVICE ON THIS
PRODUCT PLEASE CONTACT
YOUR DISTRIBUTOR, OR SIP
DIRECTLY ON:
TEL: 01509 500400
EMAIL: sales@sip-group.com or
technical@sip-group.com
www.sip-group.com**